

仅供参考

REV.	REVISION RECORD	DATE
A0	新图面发行	2017.06.16

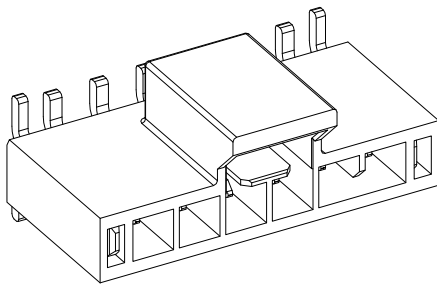

Specifications:
 Voltage Rating : 250V AC/DC
 Current Rating : 3A AC,DC
 Withstand Voltage : 1500V AC/minute
 Contact Resistance : 40mΩ(MAX.)
 Insulation Resistance : 1000MΩ(MIN.)
 Temperature Range : -40°C~+105°C

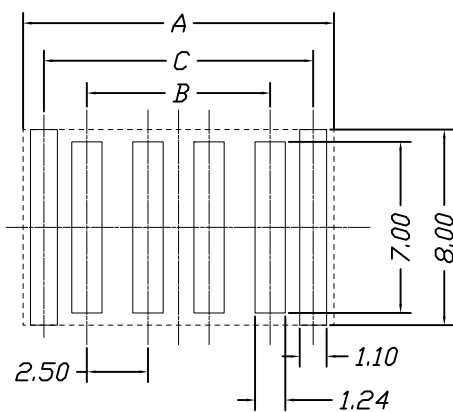
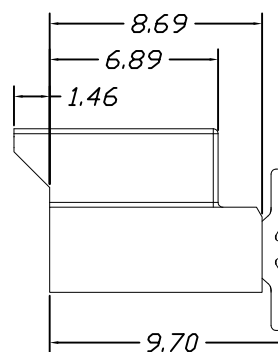
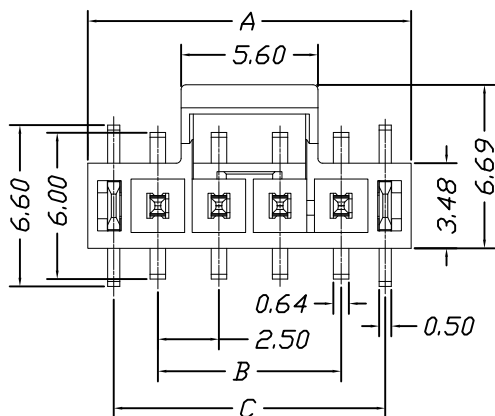

RECOMMENDED PCB LAYOUT(CONNECTOR SIDE VIEW)
 THICKNESS=1.60mm MIN. TOLERANCE: 0.05

Poles	Dimensions		
	A	B	C
2P	8.23	2.50	6.11
3P	10.73	5.00	8.61
4P	13.23	7.50	11.11
5P	15.73	10.00	13.61
6P	18.23	12.50	16.11
7P	20.73	15.00	18.61
8P	23.23	17.50	21.11

Material	Color	PIN Material
LCP	Black	Brass

	GENERAL TOLERANCES		SCALE: 1:1	NAME	DATE	深圳市思拓展电子有限公司 SHENZHEN SINOTOP ELECTRONICS CO., LTD 公司网址: www.szstuo.cn 公司电话: 0755-23765350 邮箱: 2850175982@qq.com 公司传真: 0755-23765341	PART. NO: STP42508W00-NPX-A2-XX	
	LINEAR	ANGLES	APPROVED				DWG. NO:	
	0.0±0.35	X° REF±6°	DESIGNER					
	UNIT: MM	0.00±0.25	X° ±3°	TITLE:				REV: A0
SIZE: A4	0.000±0.15	X° X'±2°	DRAWN	肖坤权	2017.06.16	2.50mm Pitch 180° Wafer SMT Type		