

仅供参考

REV.	REVISION RECORD	DATE
A0	新图面发行	2017.06.16

Specifications:
 Voltage Rating : 250V AC/DC
 Current Rating : 3A AC,DC
 Withstand Voltage : 1500V AC/minute
 Contact Resistance : 40mΩ(MAX.)
 Insulation Resistance : 1000MΩ(MIN.)
 Temperature Range : -40°C~+105°C

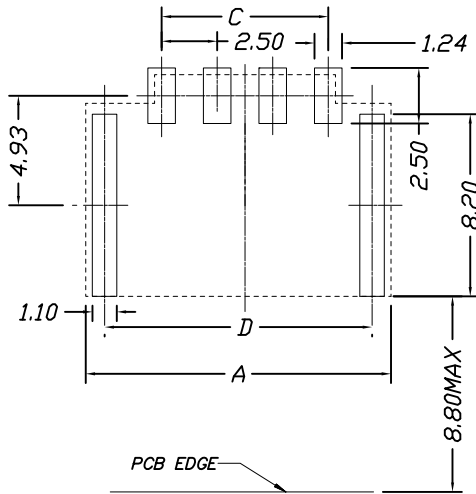
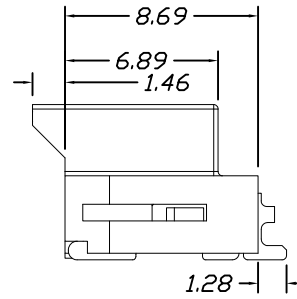
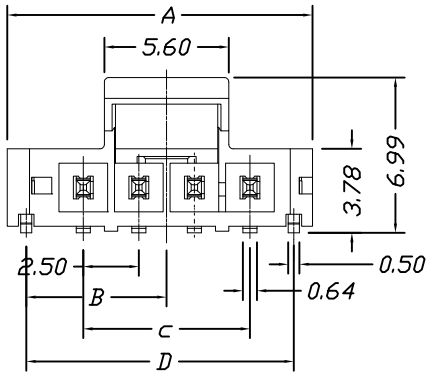
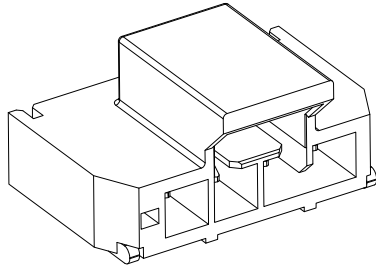

RECOMMENDED PCB LAYOUT(CONNECTOR SIDE VIEW)
 THICKNESS=1.60mm MIN. TOLERANCE:0.05

Poles	Dimensions			
	A	B	C	D
2P	8.74	3.82	2.50	7.04
3P	11.24	5.07	5.00	9.54
4P	13.74	6.32	7.50	12.04
5P	16.24	7.57	10.00	14.54
6P	18.74	8.82	12.50	17.04
7P	21.24	10.07	15.00	19.54
8P	23.74	11.32	17.50	22.04

Material	Color	PIN Material
LCP	Black	Brass

	GENERAL TOLERANCES		SCALE: 1:1	NAME	DATE	深圳市思拓展电子有限公司 SHENZHEN SINOTOP ELECTRONICS CO., LTD 公司网址: www.szstuo.cn 公司电话: 0755-23765350 邮箱: 2850175982@qq.com 公司传真: 0755-23765341	PART. NO: STP42508W90-NPX-A2-XX	
	LINEAR	ANGLES	APPROVED				DWG. NO:	
	0.0±0.35	X° REF±6°	DESIGNER					
	UNIT: MM	0.00±0.25	X° ±3°	DRAWN	肖坤权		2017.06.16	TITLE: 2.50mm Pitch 90° Wafer SMT Type
SIZE: A4	0.000±0.15	X° X'±2°				REV: A0	SHEET: 1/1	